

Alice Tarbell Cultural Space - The Preslar Gallery Floor 1 (Space #410) diagram

Total North to South
40 ft
= 13.33 yd = 480 in = 12.19 m

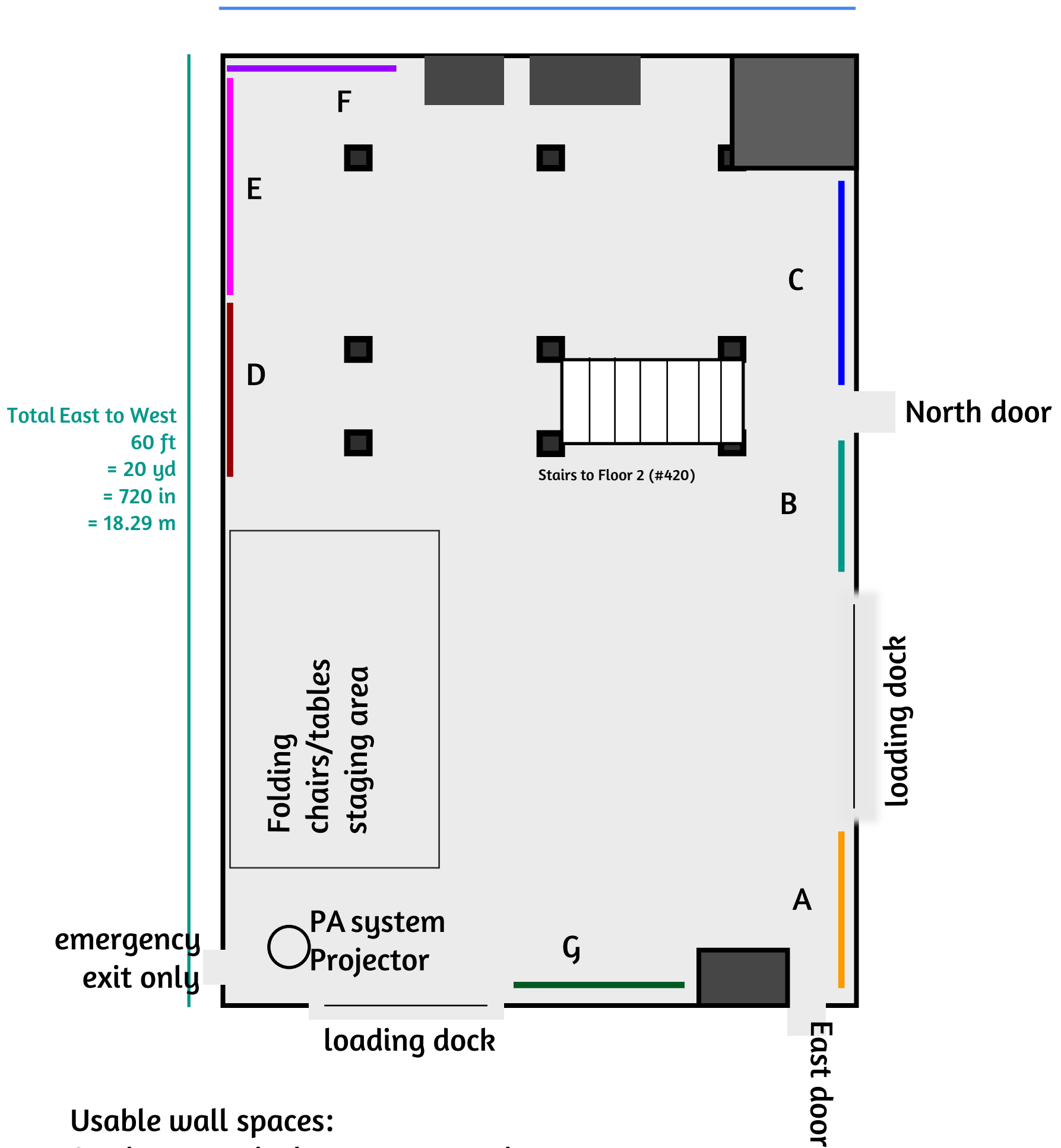

Usable wall spaces:

Section A: 60 inches = 152.4 centimetres *

Section B: 7'11" = 95 inches = 241 centimetres

Section C: 11'6" = 138 inches = 350 centimetres

Section D: 11'6" = 138 inches = 350 centimetres

Section E: 11'5" = 135 inches = 342 centimetres

Section F: 9'3" = 111 inches = 281 centimetres

Section G: 9'6" = 114 inches = 289 centimetres *

* Sections A and G are not used due to lack of good lighting at the moment